

4756 Tatum Mill Way
Chantilly, VA 20151

Toll Brothers
AMERICA'S LUXURY HOME BUILDER®

Powered by [newhomesguide.com](https://www.newhomesguide.com)

Condominium



\$576,950

3 Beds | 2 Baths | 1 Half Bath | 2 Levels | 1 Garage | 1,547 Sq Ft

About This House

Contemporary two-level condo home design available for move in this fall. Situated on the first and second floor, this home is a true respite. Keep your family close with this open concept living space overlooked by an alternate kitchen design. The stylish kitchen features name-brand appliances and quartz countertops. Upstairs, the covered porch off the primary suite and is ideal for an outdoor getaway. This low-maintenance community has lawn care and snow removal provided and is steps from shopping and dining. Don't miss your opportunity call today for an appointment! Disclaimer: Photos are images only and should not be relied upon to confirm applicable features.

About This Community

Contemporary two-level condo home design available for move in this fall. Situated on the first and second floor, this home is a true respite. Keep your family close with this open concept living space overlooked by an alternate kitchen design. The stylish kitchen features name-brand appliances and quartz countertops. Upstairs, the covered porch off the primary suite and is ideal for an outdoor getaway. This low-maintenance community has lawn care and snow removal provided and is steps from shopping and dining. Don't miss your opportunity call today for an appointment! Disclaimer: Photos are images only and should not be relied upon to confirm applicable features.

4756 Tatum Mill Way
Chantilly, VA 20151

Toll Brothers
AMERICA'S LUXURY HOME BUILDER®

Floorplans

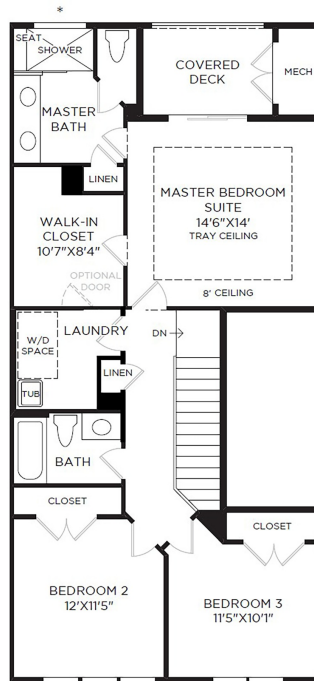

* DENOTES HIGH WINDOW

