



Base Price

\$1,876,995

4 Beds | 4 Baths | 1 Half Bath | 2 Garage

About This Plan

Just beyond the charming front porch of the Fairlane, the welcoming foyer and large flex room invite you in to discover all this home has to offer. The Fairlane's spacious great room and casual dining area with desirable rear yard access are complemented by the well-designed kitchen overlooking a bright breakfast area. The kitchen is highlighted by a large center island with breakfast bar, wraparound counter and cabinet space, and sizable walk-in pantry. Enhancing the primary bedroom suite are dual walk-in closets and an expansive primary bath with dual vanities, large soaking tub, luxe shower with seat, linen storage, and private water closet. Central to a generous loft, secondary bedrooms, two with private baths and one with a shared hall bath, feature walk-in closets. Additional

About This Community

Just beyond the charming front porch of the Fairlane, the welcoming foyer and large flex room invite you in to discover all this home has to offer. The Fairlane's spacious great room and casual dining area with desirable rear yard access are complemented by the well-designed kitchen overlooking a bright breakfast area. The kitchen is highlighted by a large center island with breakfast bar, wraparound counter and cabinet space, and sizable walk-in pantry. Enhancing the primary bedroom suite are dual walk-in closets and an expansive primary bath with dual vanities, large soaking tub, luxe shower with seat, linen storage, and private water closet. Central to a generous loft, secondary bedrooms, two with private baths and one with a shared hall bath, feature walk-in closets. Additional

Floorplans



10' CEILING HEIGHT

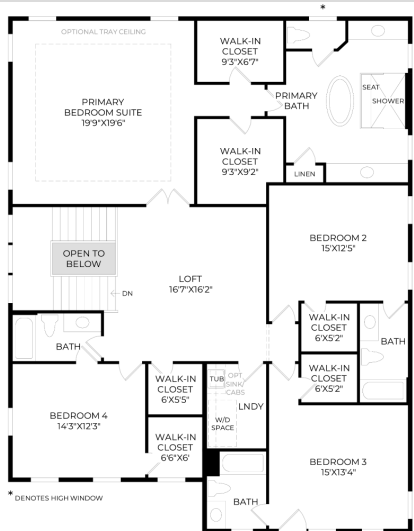

9' CEILING HEIGHT