



Powered by [newhomesguide.com](https://www.newhomesguide.com)



Base Price

**\$494,900**

**3 Beds | 2 Baths | 2 Garage**

## About This Plan

This home features 3 bedrooms downstairs, including a spacious owner's suite with bath, a large walk-in closet, formal dining room, large breakfast area, an expansive living room and much more. You can opt for a second-floor loft with bathroom, or add up to three additional bedrooms upstairs for maximum versatility.

## About This Community

This home features 3 bedrooms downstairs, including a spacious owner's suite with bath, a large walk-in closet, formal dining room, large breakfast area, an expansive living room and much more. You can opt for a second-floor loft with bathroom, or add up to three additional bedrooms upstairs for maximum versatility.

# Floorplans

THE WHATLEY

Welcome Home  
To The Whatley

The flexible, open concept floor plan gives you the space you need to live and entertain, while still keeping things cozy and convenient.

The spacious Living Room, Breakfast and Kitchen areas flow together, giving you everything you want without compromise.

The first-floor Owner's Suite does not disappoint with a large walk-in closet and bath with dual sink vanity. Two additional Bedrooms sharing a hall bath are tucked off the foyer.

The large open Kitchen boasts granite countertops and a large pantry. ■

## FIRST FLOOR PLAN

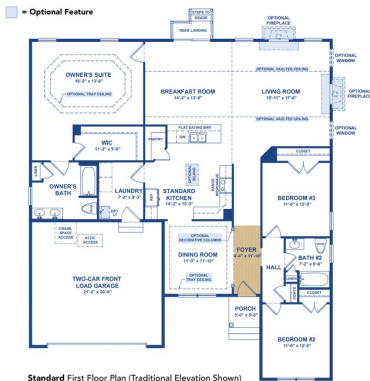

**Standard First Floor Plan (Traditional Elevation Shown)**

3

THE WHATLEY

## FIRST FLOOR OPTIONS

This Whatley model features a four foot extension all the way across the back of the home, providing even more living space.

This floor plan can be further modified, with the dining room being converted into a bedroom, study or office. ■

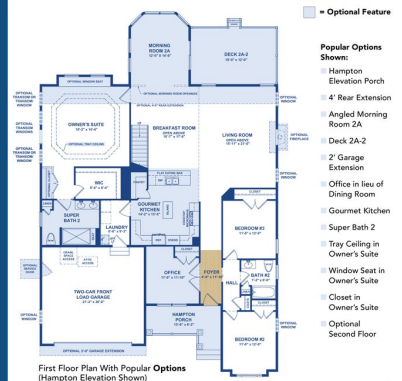

First Floor Plan With Popular Options  
(Hampton Elevation Shown)

3

THE WHATLEY

## SECOND FLOOR PLAN OPTIONS

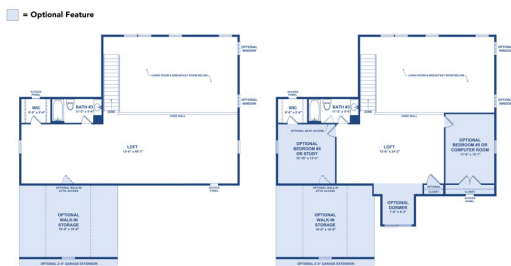

### Optional Second Floor Loft Plan

**Optional Second Floor Plan with:**

- **Optional** Bedroom #4 / Study
- **Optional** Bedroom #5 / Computer Room
- **Optional** Dormer with Closet

4

THE WHATLEY

## EXTENSION OPTIONS

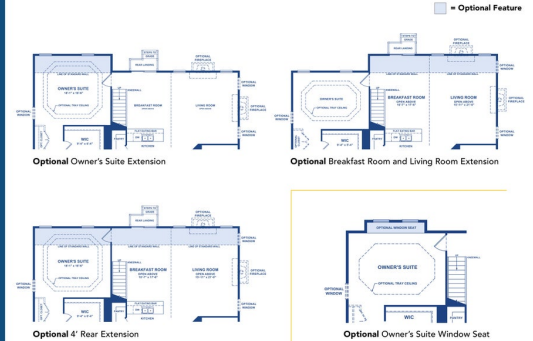

### Optional Owner's Suite Extension

### Optional Breakfast Room and Living Room Extension

### Optional 4' Rear Extension

**Optional Owner's Suite Window Seat**

5

THE WHATLEY

### GOURMET KITCHEN OPTION



### Standard Kitchen

The Standard Kitchen includes standard appliance package with microwave above a 30" range.

**Optional Gourmet Kitchen**

The Optional Gourmet Kitchen replaces the 30" range with a 36" cooktop with microwave above, adds double wall ovens and an island.

2