



Powered by newhomesguide.com



Base Price

\$604,900

4 Beds | 2 Baths | 2 Garage

About This Plan

Price includes carriage style garage door, front stone foundation, driveway entrance landscaping & premium Heritage elevation. With 4 bedrooms and 2 baths on one level, the Drake features a spacious open kitchen and private owner's suite at a tremendous value. A large entry foyer opens to an open living and breakfast area. Three bedrooms and a full bath are off to one side. Tons of cabinetry and storage round out the impressive amenities.

About This Community

Price includes carriage style garage door, front stone foundation, driveway entrance landscaping & premium Heritage elevation. With 4 bedrooms and 2 baths on one level, the Drake features a spacious open kitchen and private owner's suite at a tremendous value. A large entry foyer opens to an open living and breakfast area. Three bedrooms and a full bath are off to one side. Tons of cabinetry and storage round out the impressive amenities.

Floorplans

THE DRAKE

Welcome Home To The Drake

The Drake offers single level open-concept living designed for a casual lifestyle.

For example, the breakfast and living rooms have a 4-foot extension option for added room. You can also choose to make the middle bedroom a study, with or without double doors.

With four bedrooms on one level, a spacious open concept living, kitchen and breakfast area and a number of ways to personalize the plan to your liking, the Drake is a terrific floor plan for those seeking single level living. ■

All dimensions are approximate. Floor plans are subject to change without notice. Prices and dimensions may show options not included in the base price. Details subject to change without notice.

FIRST FLOOR PLAN

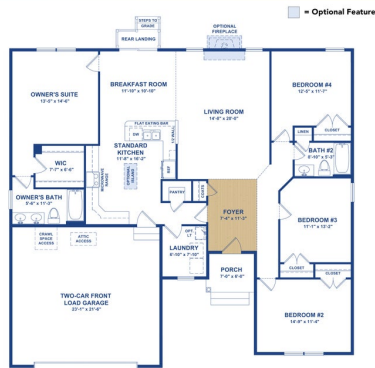

Standard First Floor Plan (Traditional Elevation Shown)

2

THE DRAKE

You can expand the flexible Drake plan, adding additional square footage for a variety of uses.

Popular structural options include a large morning room, an extension on the owner's suite, breakfast and living rooms, and owner's suite bath options.

You can also choose to make bedroom #3 a study, with or without double doors. ■

FIRST FLOOR OPTIONS

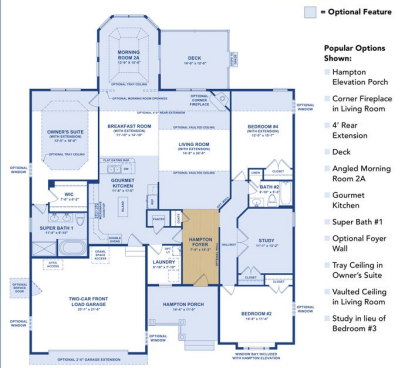

First Floor Plan With Popular Options (Hampton Elevation Shown)

3

THE DRAKE

EXTENSION OPTIONS

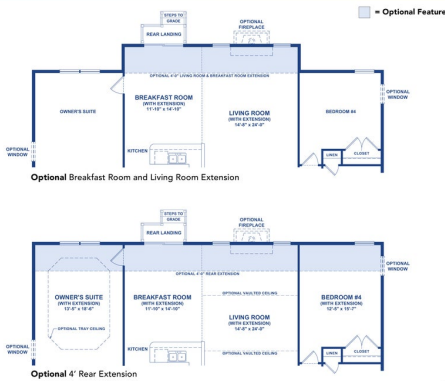

Optional Breakfast Room and Living Room Extension

Optional 4' Rear Extension

4

THE DRAKE

Rise And Shine In This Glorious, Light-Filled Morning Room!

An optional Morning Room is available in two sizes and designs, square or angled.

Both of these rooms provide spacious, bright living space which include Insight's exclusive Low-E windows which reduce energy transfer - keeping the heat out in summer and the cold out in winter.

This is truly a comfortable room to enjoy in all seasons. ■

SQUARE MORNING ROOM OPTIONS

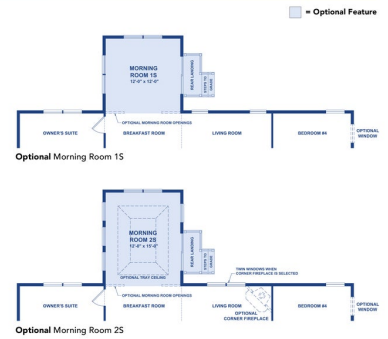

Optional Morning Room 15

Optional Morning Room 25

5

THE DRAKE

ANGLED MORNING ROOM OPTIONS

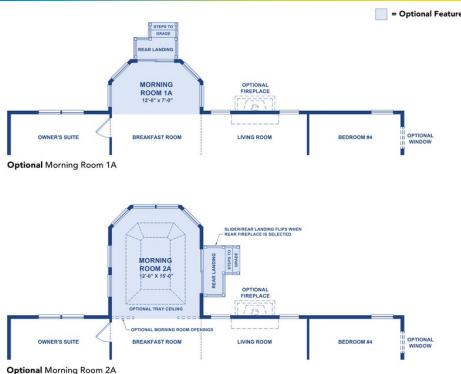

Optional Morning Room 1A

Optional Morning Room 2A

6